

Connecting Both the Nintendo 64 and Super NES

**There is no reason to disconnect your Super NES; you can connect both the Nintendo 64 and the Super NES!** Use one of the connections described below to connect the Super NES *and* Nintendo 64, then enjoy playing games on both systems.

- If the Super NES is currently connected to your TV using an RF Switch, then use the Stereo Audio/Video Cable to connect the Nintendo 64 Control Deck to your TV (see diagram #1 below). For connection details, use method A on Page 4.
- If the Super NES is currently connected to your TV using an RF Switch and your TV has no AV inputs, connect the Nintendo 64 Control Deck to your VCR (see Diagram #2 below). For connection details, use method B on page 5.
- If the Super NES is currently connected to your TV using an RF Switch and your TV or VCR does not have any audio/video connections, then connect both the N64® and Super NES Control Decks by using two RF Switches (see Diagram #3 below).
- If the Super NES is currently connected to your TV or VCR using an audio/video cable, then use the Stereo Audio/Video Cable that came with the Nintendo 64 to connect the Control Deck to either your TV or VCR. Follow one of the connection methods shown on pages 4-6. If there are no additional audio/video connections available, then connect the Nintendo 64 using the existing audio/video cable connection (so you can enjoy the stereo sound and best picture quality) and connect the Super NES Control Deck by using an RF Switch (use the RF Switch that came with your Super NES). (See Diagram #1 below.)

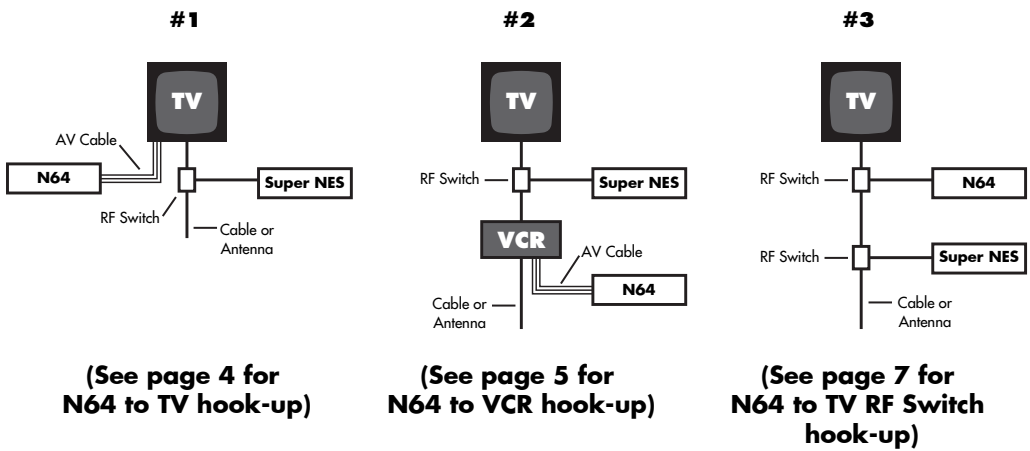

Connecting the AC Power Supply

Make sure the Power Switch is in the OFF position before connecting the AC Power Supply.

Connect the AC Power Supply, with the triangle on top as shown, into the port in the back side of the Control Deck. Insert the AC Power Supply into the Control Deck until you hear a click.

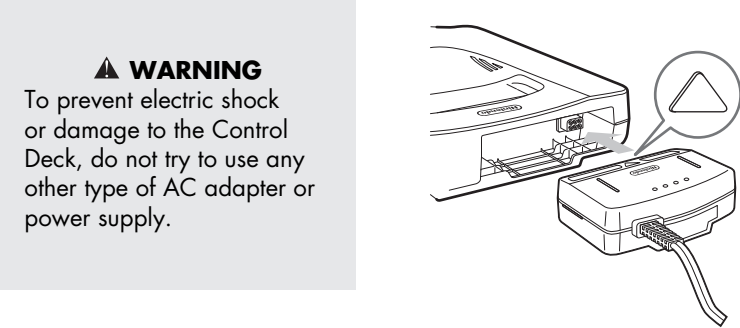

Insert the plug from the power cord into a standard (120-volt AC) wall outlet.

- If you need to remove the AC Power Supply from the Control Deck, first make sure the power switch is in the OFF position, then disconnect the power cord from the wall outlet. Press the lock release button on the bottom of the AC Power Supply and pull it out of the Control Deck.

**⚠ WARNING**

To prevent electric shock or cord damage, carefully disconnect any plugs from the Control Deck or electrical outlet by pulling the plug, not the cord.

**⚠ CAUTION**

To avoid excessive wear to the AC power supply connector, do not disconnect the AC Power Supply from the Control Deck even when storing your Nintendo 64. To save energy, unplug the power cord plug from the wall outlet when the Nintendo 64 is not being used.